

SALTBUSH

STAFF REQUIREMENTS:

Tech Crew

1 x Light Technician, 1 x Sound Technician and 1 x Stagehand during load in and load out.
1 x General Light/Sound/Rigging Technician for assistance during shows

Ushers Crew

2 x Ushers are needed during the audience entrance and exit and for the whole duration of the show.

Cleaning Crew

1 x cleaning person to clean (mop) the carpet space at the beginning of each performance day.

TECHNICAL REQUIREMENTS:

Light

16 x Fresnel 1000 watts with barn doors: 8 for the performative space (Flood marked "A" on the rigging plan) and 8 for audience (pointing down on the risers and marked "B" on the rigging plan)

Please note: the audience lighting can also be achieved with 8 x Source Four ERS.

4 x Fresnel 2000 watts with barn doors (to be used for the bows, marked "C" on the rigging plan)

12 x Source Four (ERS) to be mounted on 6 side trees or booms (marked "D" on the general view)

2 x Source Four (ERS) in case an interpreter is needed during the show (marked "E" on the rigging plan)

4 x Source Four (or Fresnels) for the audience entrance (optional)

8 x blue gels 363 "medium blue" for the Flood lights (marked "A" on the rigging plan)

12 x frost gels 119 for the side ERS's

1 x fully patchable digital lighting console/desk

Power lines and cables.

In some spaces it will be necessary to provide more lights such as Fresnel or Source Four to create an entrance-light situation to get the audience into the space safely.

Video

2 x 20m VGA cables, 1 x 20m XLR cable

Sound

4 x speakers rigged or flown at the 4 corners of the carpet.

2 x subwoofers.

Meyer Sound, D und B Audiotechnik, Nexo or similar brands preferred.

2 channels of Direct Injection (D.I.) (Radial, BSS or similar preferred)

1 x sound mixer minimum 6 channels with two pre-fader aux sends.

1 x miniature capsule radio mic system comprised of a body-pack transmitter, a receiver and a DPA 4060 capsule. The color of the capsule should be "flesh" or "beige".

ONLY FOR NON-ENGLISH SPEAKING COUNTRIES: 1 x handheld radio mic system comprised of a handheld transducer/transmitter and a receiver.

All the required amplifiers and cables.

Misc.

1 x console table (200/250 x 80/100 cm)

SCENIC REQUIREMENTS

Space

An empty space/stage (minimum 18 x 12 m) with rigging at ~6.80m (see the plan) for the video projectors

The space must be darkened and warm and should be empty without wing flats.

The walls should be covered with black curtains/drops.

The floor must be smooth without holes, screws or splinters.

Sound and lighting consoles are to be placed on the stage close to the scenery.

An empty space for the introduction, see below.

IMPORTANT: the lens of the video projectors must be at ~ 6.50m (~21.3 feet) height, so the bar to hang up the video projectors must be at ~6.80m (~22.3 feet) height, the actual height of the bar may vary slightly (±10 cm) due to the type of rigging the company will provide, it is thus vital that the rigging point be movable and adjustable.

The distance of the two projectors' rigging points shall be no less than 5.10m (16.75 feet).

The venue MUST also provide a safe and convenient way for the company's Technical Director to reach the video projectors once in place (Genie, scissor lift or A-frame ladder.)

Carpet

- White dance floor in rolls (tarkett): thickness 1.7mm, weight 1750 gr/mq, composition 100% PVC, width 140 cm, length 30m (3 stripes of 10m)

(like this http://www.peroni.com/lang_UK/scheda.php?id=52534&idCat=136).

you can use different width rolls, in any case the surface to cover is 10m x 4.20/5m

A 10m x 4m floor linen surface like this: <http://www.ikea.com/us/en/catalog/products/00018076>

Important: the dance carpet **may** be provided by the company, please inquire with company's Tech Director.

- Black dance floor in rolls or black carpet in rolls to "frame" the projected image on the white carpet (two 10m rolls + two 5m rolls). This greatly enhances the perception of the projected image.

- 1 roll of white gaffer tape to fix the white dance floor (1 roll each setup)
- 1 roll of white "marly/tarkett" tape mod. "stylus 471" 48x33mm (1 roll each setup)
- 1 x roll of black gaffer tape
- 2 rolls of black electrician's tape
- 1x roll of yellow spike tape
- cleaning equipment for the carpet and floor

Seatings

The seating should be bleachers or a series of interconnected risers which allow the children easy access to the carpet with enough room for the adults to sit in the back rows. Please see attached images for a diagram which shows how the seating should be constructed and positioned

Misc.

The presenter needs to supply 4 posts painted black with 1 eyelet each and in place to the stage floor with weights at the diagonal corners of the carpet.

is to hook a gauze cloth which hangs loosely over the entire projection surface (see photo attached and image on the map).



held
This

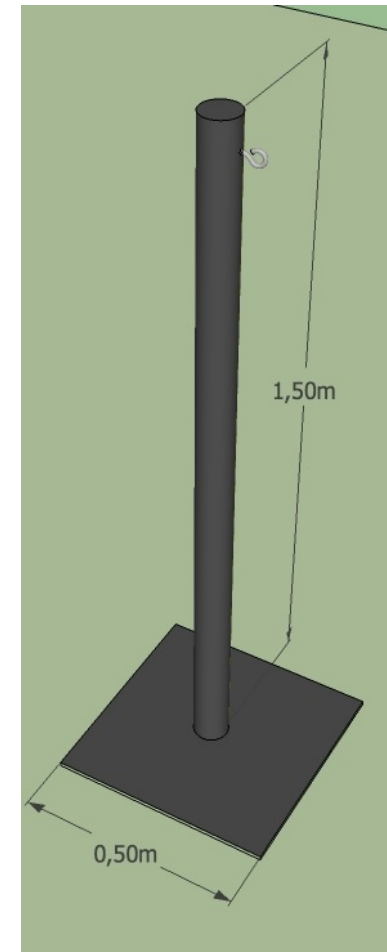

FEATURES

Allowance

Using a seating system similar to the one suggested in page 11 allowance is around 140 spectators, adults and children (4-8 years old) Audience is required to take off their shoes, this should be done outside the performing space.

Duration

The show's duration is of about 50 minutes.

FACILITIES REQUIREMENTS

Cleaning

The performing space (carpet and surrounding area) should be cleaned by the cleaning staff crew at the beginning of each performing day and be ready for the performers at least 1 1/2 (one and a half) hours before the first performance.

Access to Performing space

The full technical and artistic staff should be able to access the performing space and the dressing room at least 1 1/2 (one and a half) hours in advance of each show. The full lighting and sound system should be fully functional by that time.

Dressing rooms

The dressing room(s) must be adequately heated/air-conditioned, adequately illuminated and should provide a direct path to the performing space. The path from the dressing rooms to the performing space should not be adjacent to the audience entrance path.

Washing Machine

The performers' costumes will need to be washed every day at the end of the last performance scheduled, a washing machine with "delicate" washing capabilities is required.

The costumes will be "tumble" dried and then hung for drying.

No heated air machine drying, please.

Load in time: 8 hours

Load out time: 2 hours

**General
View:**

Please note
position of
Side Lights
("D").

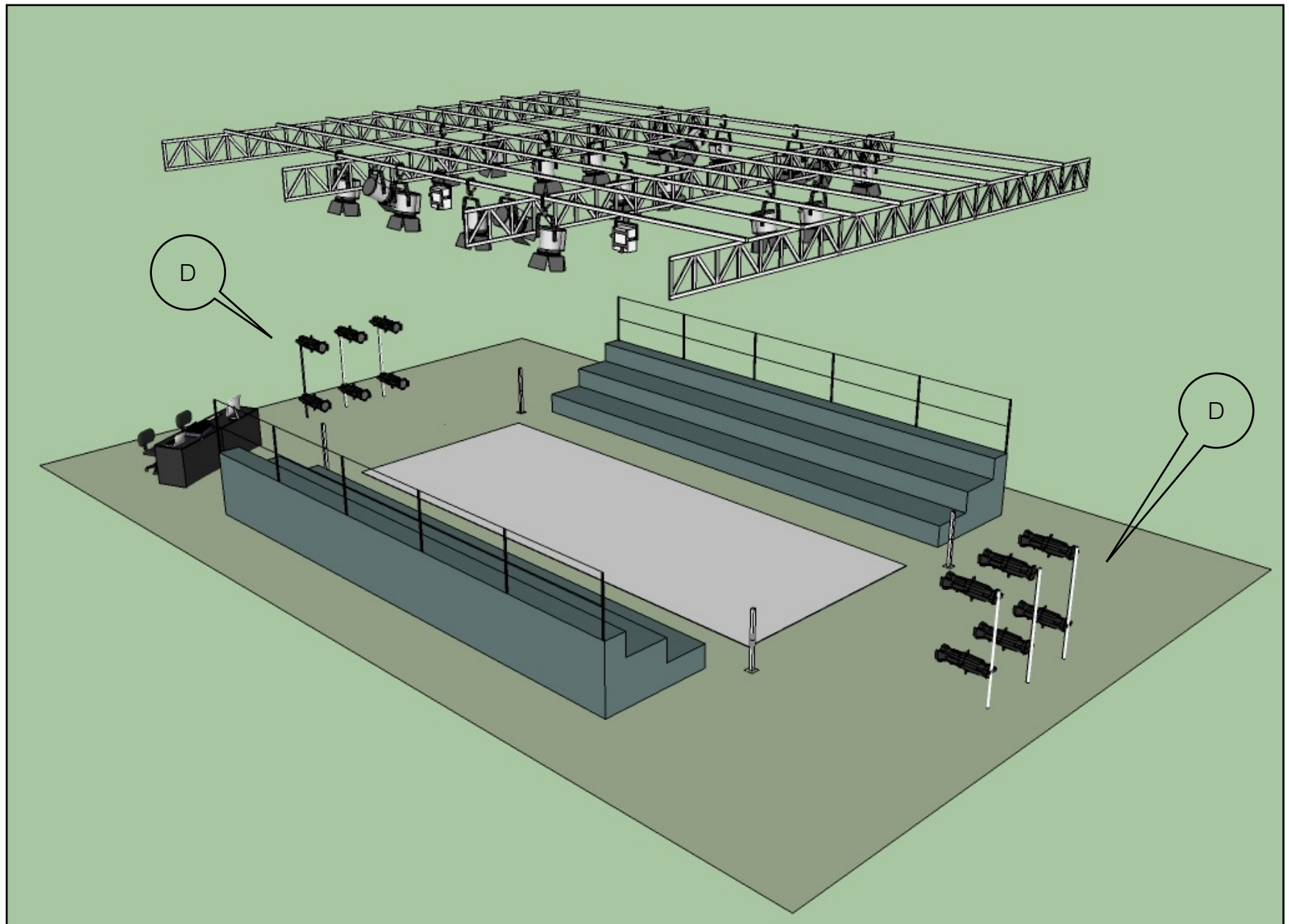

**Top View
With
Measures:**

Actual
carpet
dimensions
may slightly
vary.

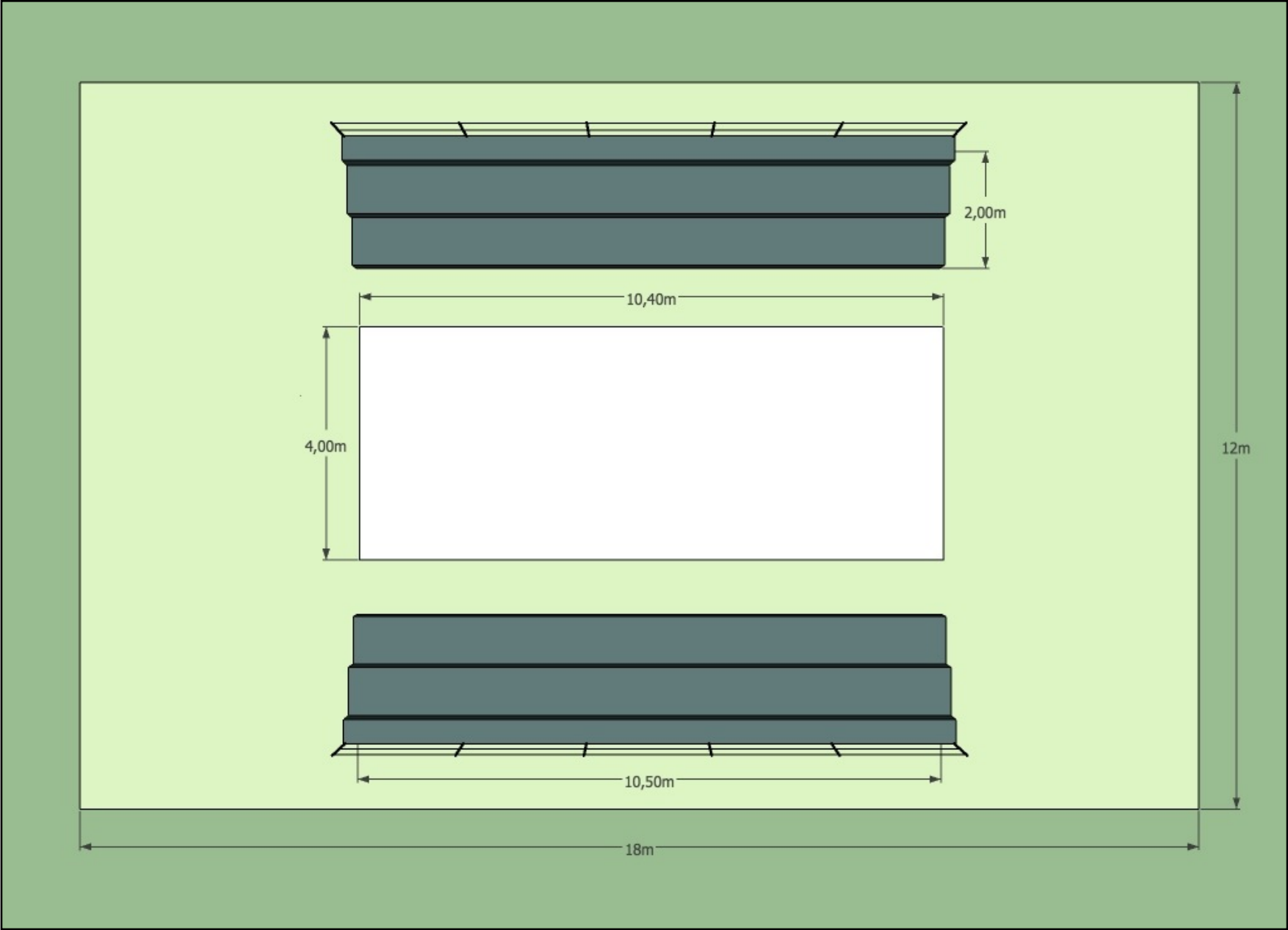

Light Rigging Plan:

Legend:

A: Flood Fresnels with 363 "Medium Blue" gels

B: Seating Lights (Fresnel or Source Four), no gels.

C: Bow Lights (Fresnel or Source Four) no gels.

E: Optional Source Four Profilers no gels.

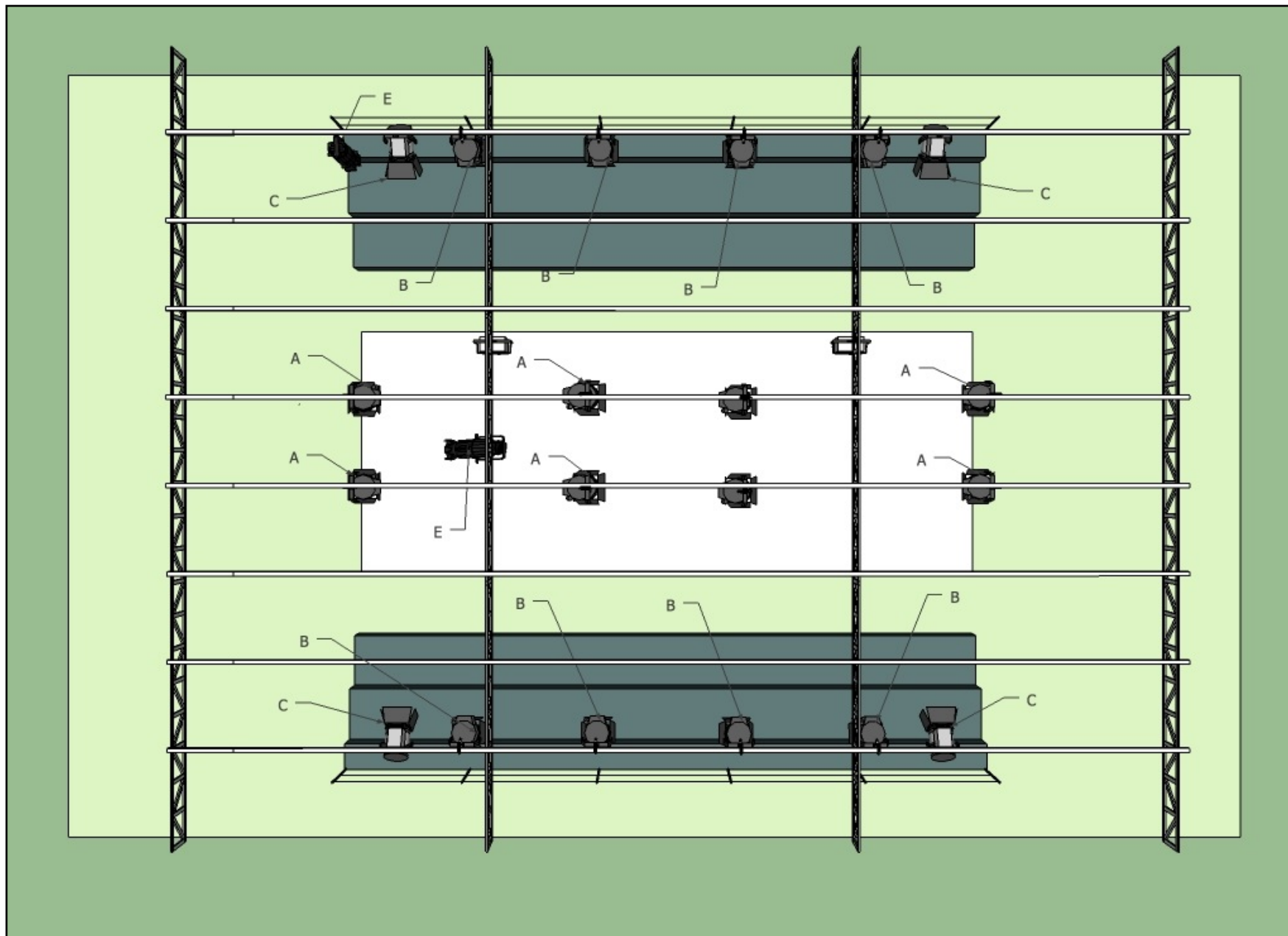

Projectors' Height Detail:

Height and distance are variable, ***the rigging points must be adjustable in height and width.***

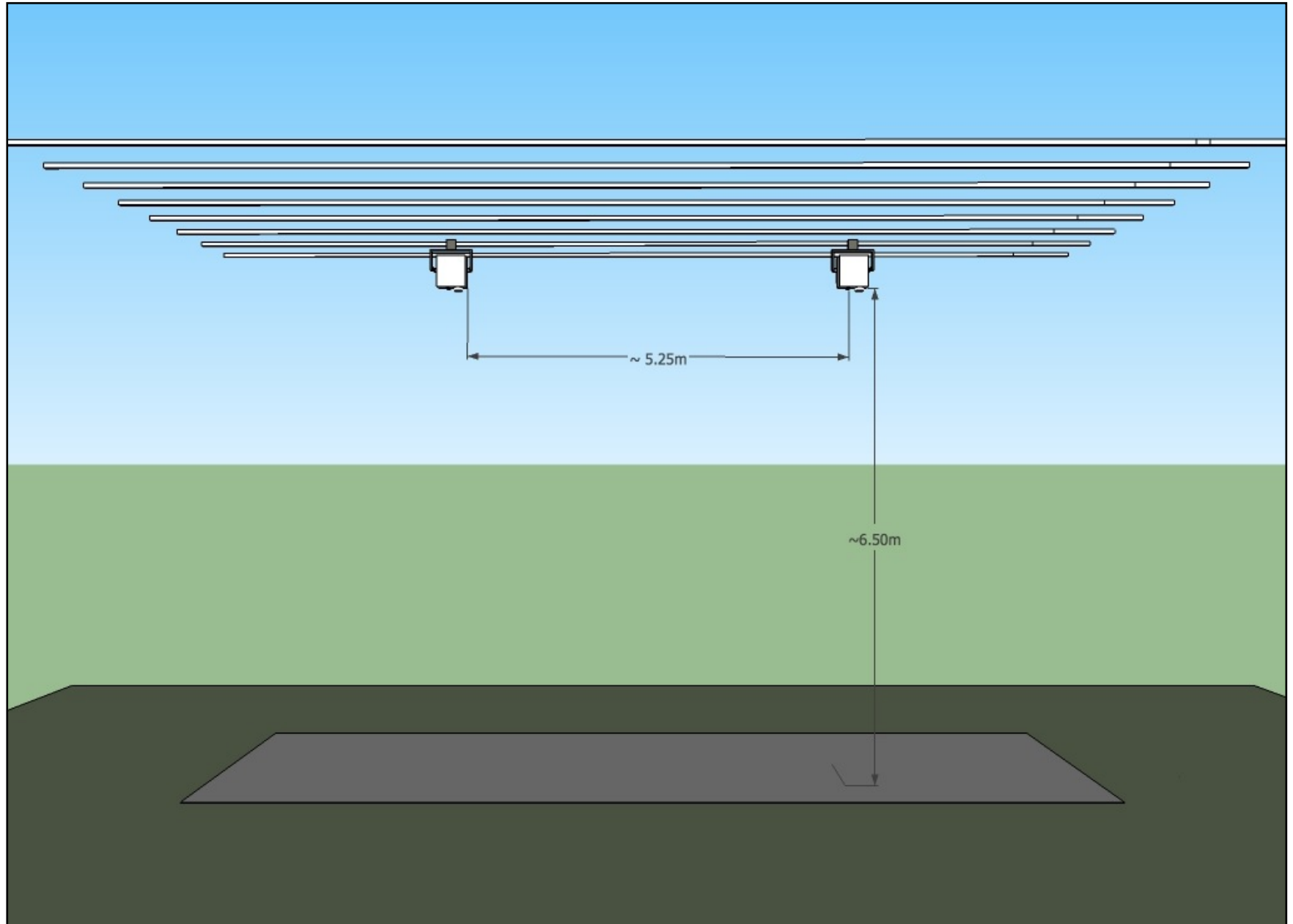

**Side Trees
Detail:**

The Side
Trees should
be no nearer
to the carpet
than ~3
meters.

top row
height:
1.80m

bottom row
height:
0.60m

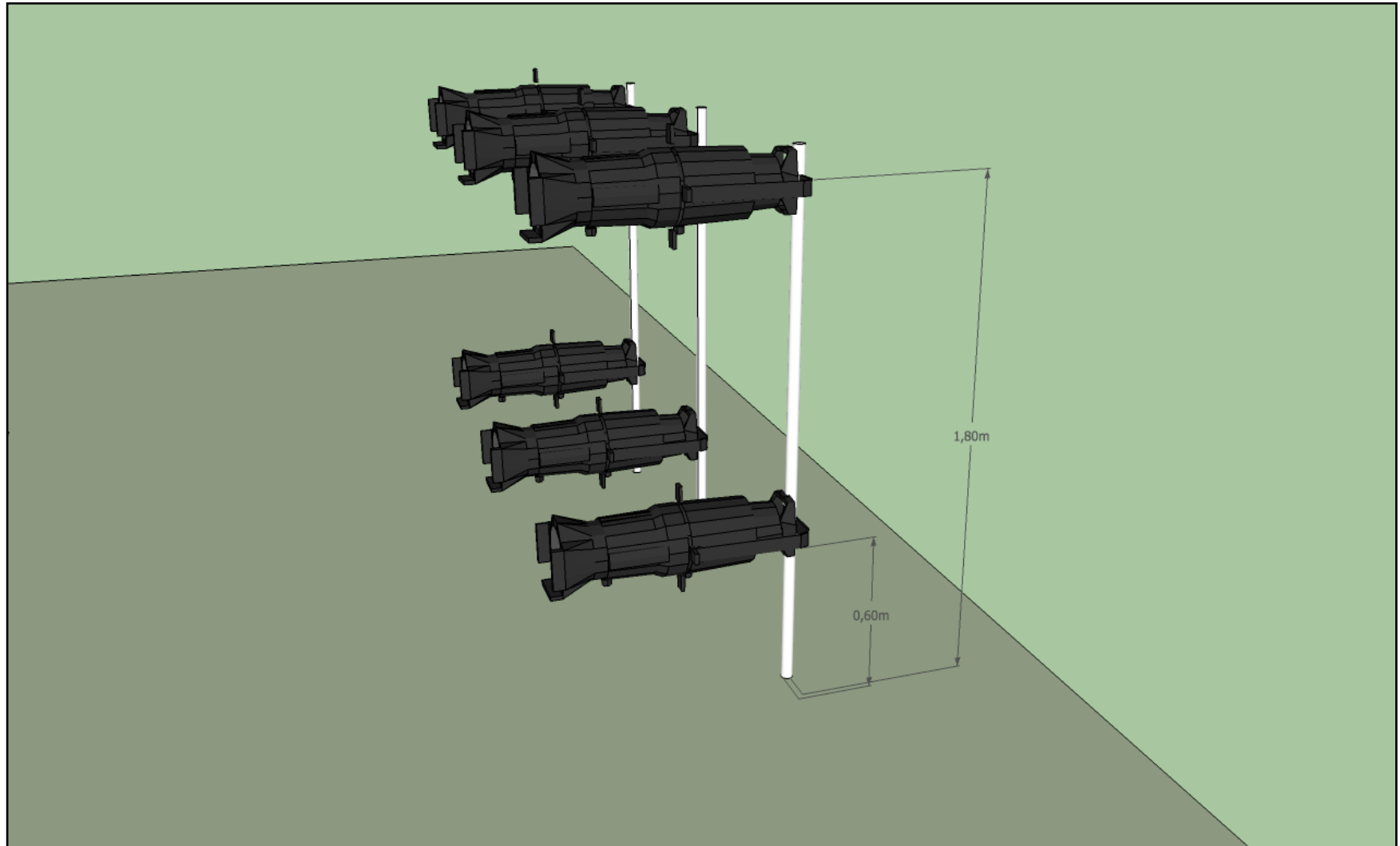

**Scrim Poles
Positioning:**

Please note:
the actual
positioning
may vary
slightly,
please do not
fix the poles
to the floor.

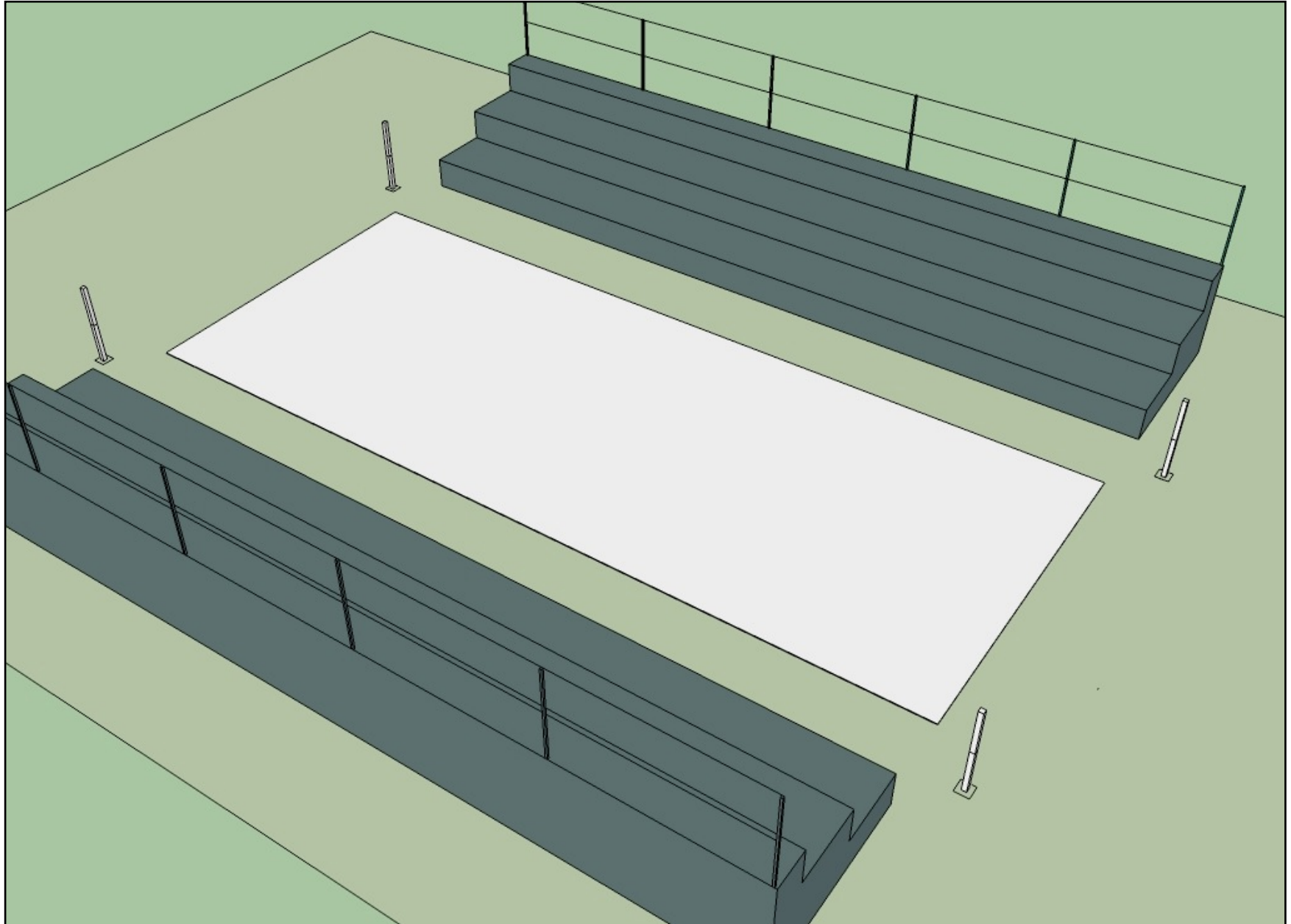

Seating Setup Suggestions:

The following are just two suggestions for the setup of the seatings, setup "A" is recommended: the use of chairs in the topmost row is especially comfortable for elderly audience members.

Please note that the use of chairs for all the audience is strongly advised against, as the use of chairs for the front rows seriously limits allowance and general interactivity.

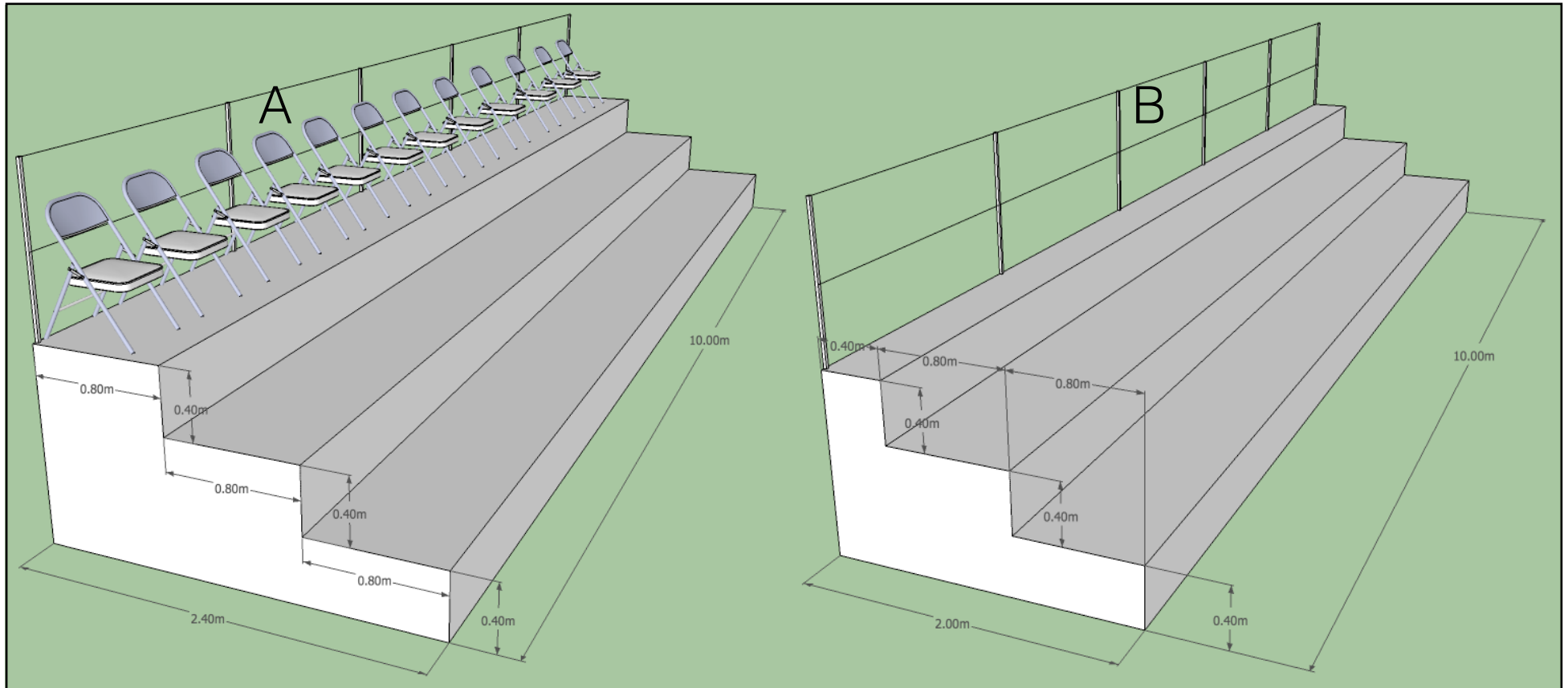

Appendix A

audio and lights routing/patching:

Please note that the Video, Audio and Lights elements of the show are all operated by a single person, it is thus important that the lights and audio desks are placed on a control table of a size big enough to accomodate them plus two laptop computers and one controller (provided by the company.)

Audio Patching/Routing:

Input:

The main sound for the show is coming from a laptop computer in the form of two 1/4 inch jacks. These will input into two channels of D.I. and into channels 3 and 4 of the mixing desk.

Lavalier microphone into channel 1 and handheld microphone into channel 2.

Patching:

Channel 1 should be patched to aux 1 pre-fader and to main L/R bus.

Channel 2 should be patched to aux 2 pre-fader and to main L/R bus.

Channels 3 and 4 should be panned left and right and paired if possible. Patched to aux 3 post-fader and main L/R bus

Output:

Aux 1 and Aux 2 outputs will go to the audio laptop via cables provided by the company.

Aux 3 output should be patched to the Subwoofers if possible.

L/R mains will go to the speakers as shown on the rigging plan.

Lights Patching:

Lights are operated via sub-masters, no cues.

Sub-master 1: Side Source Fours ("D") @25%

Sub-master 2: Blue Flood ("A") @full

Sub-master 3: Bows Lights ("C") @full

Sub-master 4: Seatings Lights ("B") @full

Sub-master 5 Seatings Lights ("B") @10%

Additional patching may be needed according to particular needs (i.e. translator lights, intro speech and/or audience entrance.)